

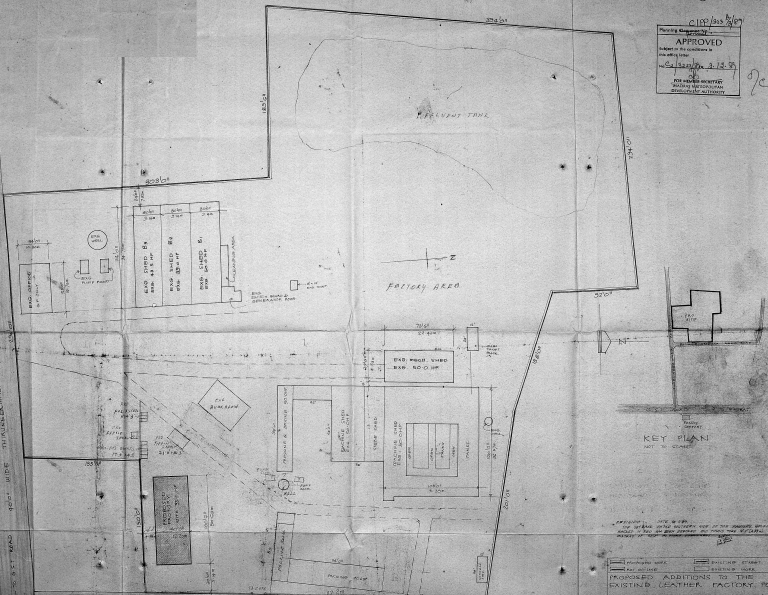

C 137 Bas 2/17  
 Planning Commission  
**APPROVED**  
 Subject to the conditions of  
 the site plan  
 24/1/2019 3.13.19  
 For further information  
 contact the authority



KEY PLAN  
NOT TO SCALE

APPROVED 10/11/19  
 The Urban and Rural Development Committee of the Council of the City of London has approved the site plan for the proposed development of the site.

PROPOSED ADDITIONS TO THE  
 EXISTING LEATHER FACTORY FOR  
 THE GENERAL & INDUSTRIAL  
 LEATHERS UNIT OF  
 AT 5/6, 00/1, OF FARMIL VILLAGE  
 SAFFORD TRAFFIC  
 CENTRAL/POSTAL DISTRICT

1. A FACTORY AREA OF 0.5 HA GRASS
2. SITE OF PRE-EXISTING RAG MANUFACTURE OF 0.2 HA OFFERS IN 2018 RAG
3. PUBLIC ROADS ARE SHOWN GREEN

SITE PLAN  
 SCALE: 1:500 (1" = 50')

DRAWN BY: [Signature]  
 CHECKED BY: [Signature]  
 DATE: 10/11/19  
 PROJECT NO: [Number]  
 SHEET NO: [Number]